

POTPORNI TIP
KALOTA K - 3/2,02
STEPENICA S - 2/1,86
PODNOŽNI SVOD TO - 4/1
M 1:200

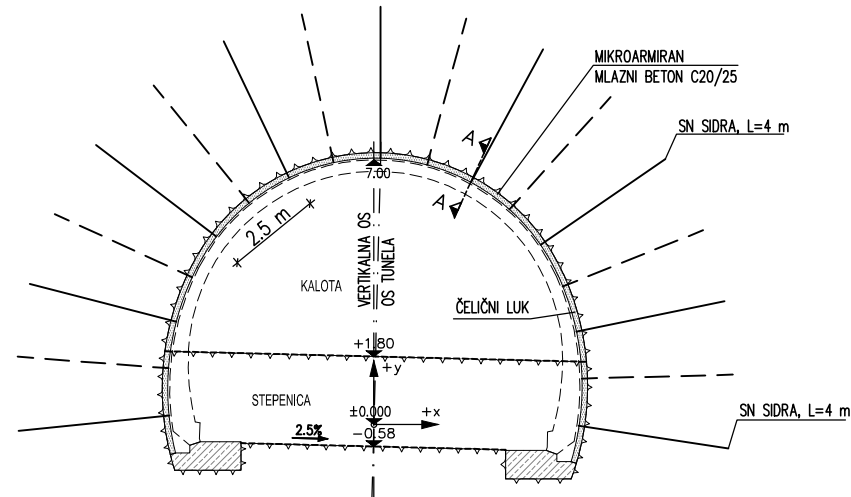

SUPPORT MEASURE
TOP HEADING K - 3/2,02
BENCH S - 2/1,86
INVERT TO - 4/1
M 1:200

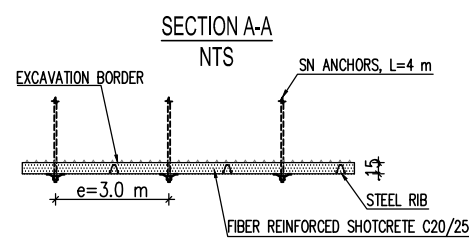
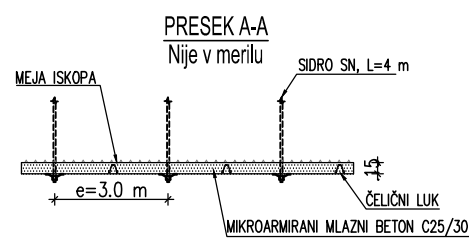
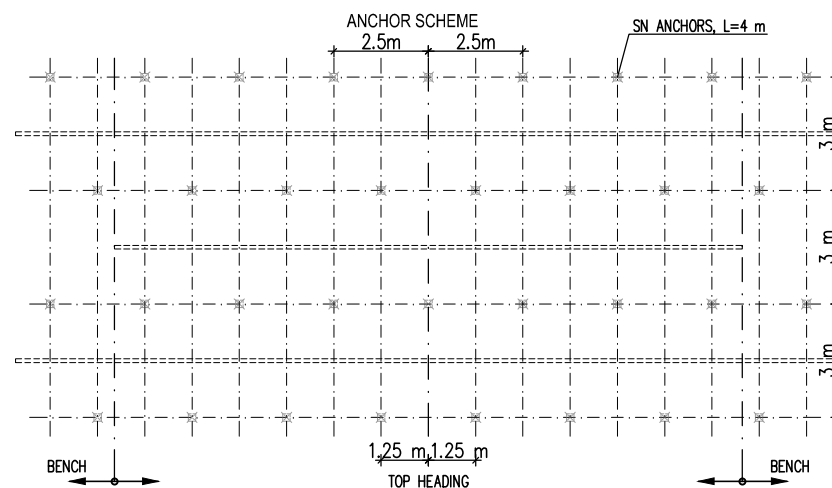
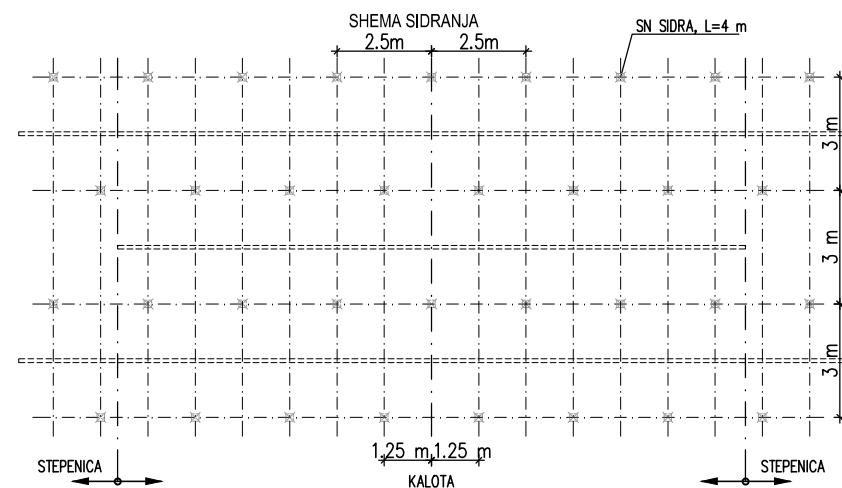
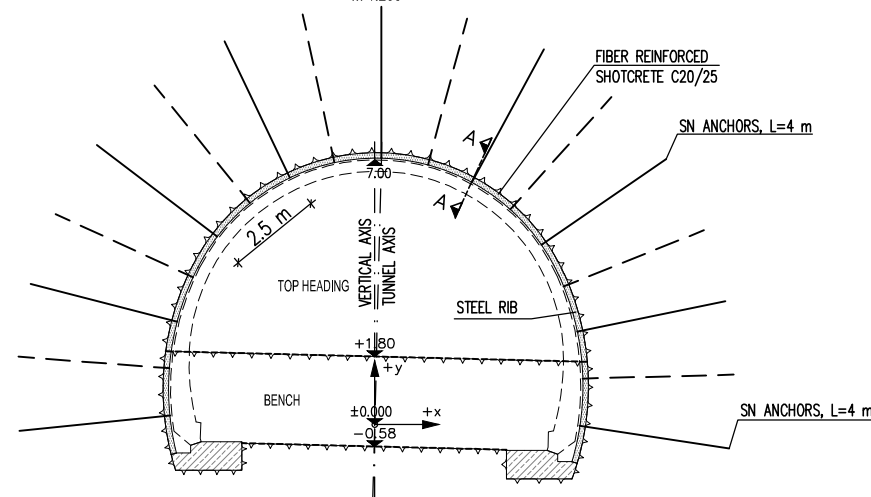

POTPORNI TIP K-3/2,02; S-2/1,86; TO-4/1

Maksimalni iskopni korak

T	3,0m
B	6,0m
I	12,0m

LEGENDA

T	... KALOTA
B	... STEPENICA
I	... PODNOŽNI SVOD
F	... ISKOPNO ČELO
R	... PLAFON
S	... STRANA
TI	... PRI. PODNOŽNI SVOD

SUPPORT TYPE K-3/2,02; S-2/1,86; TO-4/1

Maximum round length

T	3,0m
B	6,0m
I	12,0m

LEGEND

T	... TOP HEADING
B	... BENCH
I	... INVERT ARCH
F	... EXCAVATION FACE
R	... ROOF
S	... SIDEWALL
TI	... TEMP. INVERT

LOKACIJA	VREME UGRADNJE	POTPORNE MERE	Količina/m
KALOTA	ISKOPNA KOLIČINA		47,15 m ³
R	pre iskopa sledećeg koraka	mikroarmirani mlazni beton C20/25, ds=15cm	16,75 m ²
R	najviše jedan korak za iskopni čelom	SN sidra, l=4m	2,17 kos
R	pre iskopa sledećeg koraka	čelični luk TIP95/30/20	0,073 t
STEPENICA	ISKOPNA KOLIČINA		30,74 m ³
S	pre iskopa sledećeg koraka	mikroarmirani mlazni C20/25, ds=15cm	5,56 m ²
S	najviše jedan korak za iskopni čelom	SN sidra, l=4m	0,66 Kos
S	pre iskopa sledećeg koraka	čelični luk TIP95/30/20 (svak 2. korak)	0,012 t
PODNOŽNI SVOD	ISKOPNA KOLIČINA		2,78 m ³
I	nakon iskopa podnožnog svoda	beton u tenelju C25/30	2,41 m ²

NAPOMENA: KVANTITETE SU IZRAČUNATI NA TEKUĆI METAR TUNELA SA ISKOPNIM KORAKOM DUŽINE 3,0M. KVANTITE ISKOPA JE TEORETSKI I BEZ TOLERANCIJA.

LOCATION	TIME INSTALATION	ROCK SUPPORT	Quantity/m
TOP HEADING	VOLUME OF EXCAVATION		47,15 m ³
R	prior to excavation of next round	shotcrete C20/25, ds=15cm	16,75 m ²
R	max. one round behind excavation face	SN anchor, l=4m	2,17 Pc
R	prior to excavation of next round	čelični nosilac TIP95/30/20	0,073 to
BENCH	VOLUME OF EXCAVATION		30,74 m ³
S	prior to excavation of next round	shotcrete C20/25, ds=15cm	5,56 m ²
S	max. one round behind excavation face	SN anchor, l=4m	0,66 Pc
S	prior to excavation of next round	steel rib TIP95/30/20 (every 2. round length)	0,012 to
INVERT	VOLUME OF EXCAVATION		2,78 m ³
I	after excavation of invert	abutment concrete C25/30	2,41 m ²

REMARK: QUANTITIES ARE CALCULATED FOR A ROUND LENGTH OF 3,0m. EXCAVATION VOLUMES GIVEN IN THE TABLE ARE THEORETICAL WITHOUT ANY TOLERANCES

br./no.	promena/change	datum/date	ime/name

klijent/client:



naslov/title:

SRSDD Standardni crteži putnih detalja u Republici Srbiji
SRSDD Serbian road standard detail drawings

crtež/drawing:

Potporne mere
Support measures